

# Comfortable streets,

action to adapt to the climate crisis

GROUND: BREAKING SEMINAR  
13.5.2024

MAŠA CVETKO

prostorož



# Concept

Woonerf, Living streets, superblocks, school streets...



# Criteria for Planning

- Traffic slowdown
  - Road width, meandering, greenery, barriers, paving...
- Creating a pleasant street space
- Traffic congestion
- Clearly designed entry
- Universal accessibility
- Promoting sustainable mobility
- Improving soil permeability
- Increasing the amount of green space



# Past projects

Traffic calming, promoting sustainable mobility, street cooling, greening...



# Comfortable Streets

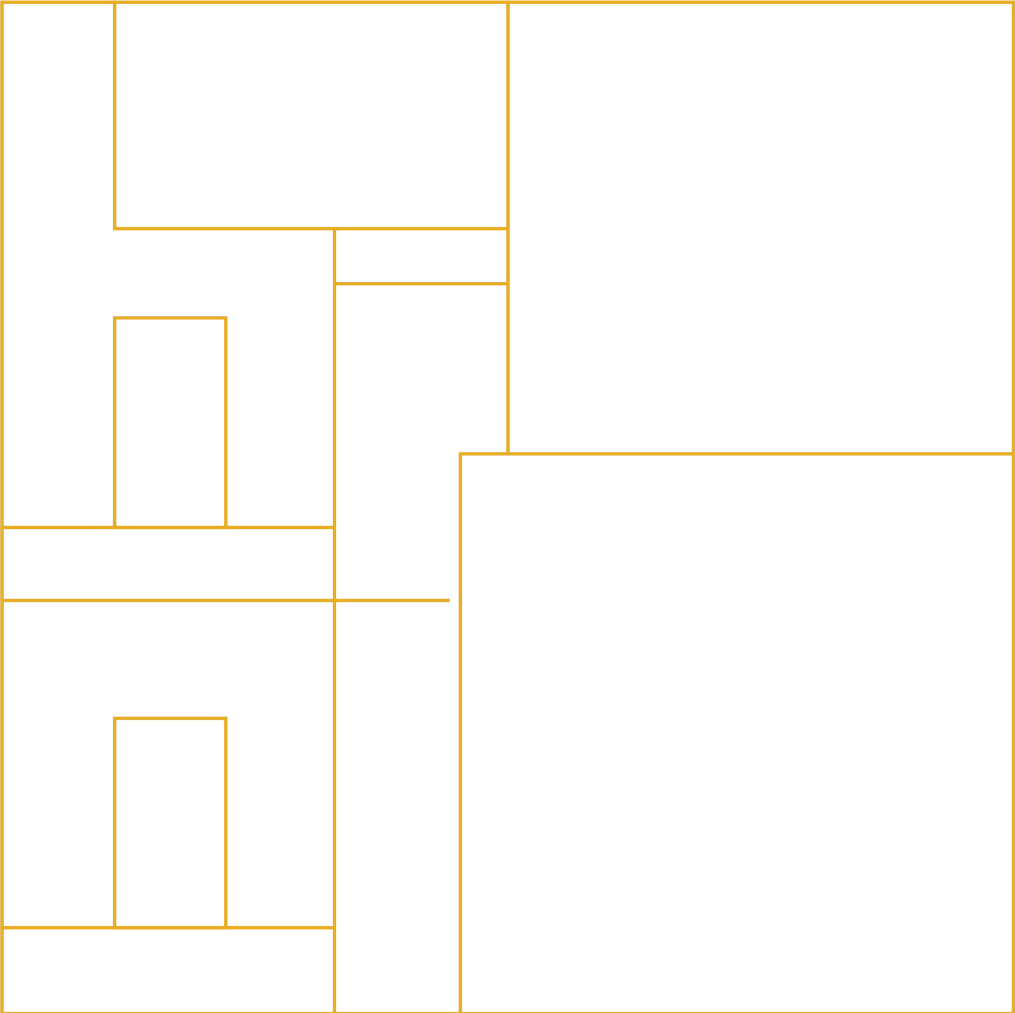

# Kindergarten accessibility

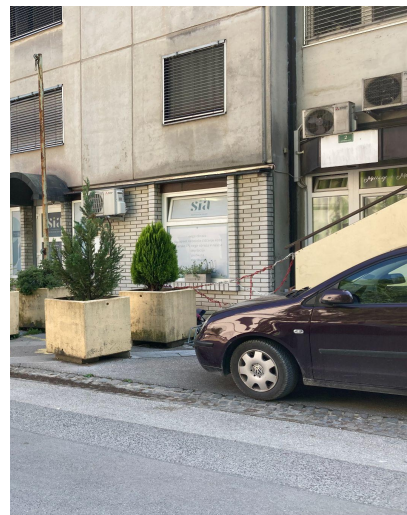
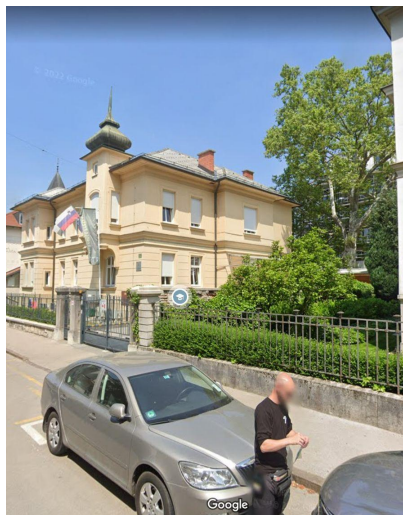

# Mislejeva street, Ljubljana

## Kindergarten Kostanjček



# Renovation phase 1







# Survey

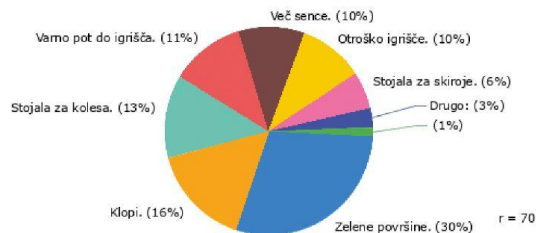

## STARŠI:

*Kaj v bližini vrtca najbolj pogrešate vi?*



## STARŠI:

*Kaj v bližini vrtca najbolj pogreša vaš otrok?*

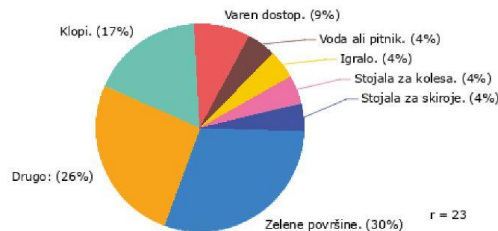

## VZGOJITELJICE:

*Kaj po vašem mnenju najbolj primanjkuje v neposredni bližini vrtca?*

# Implementation plans

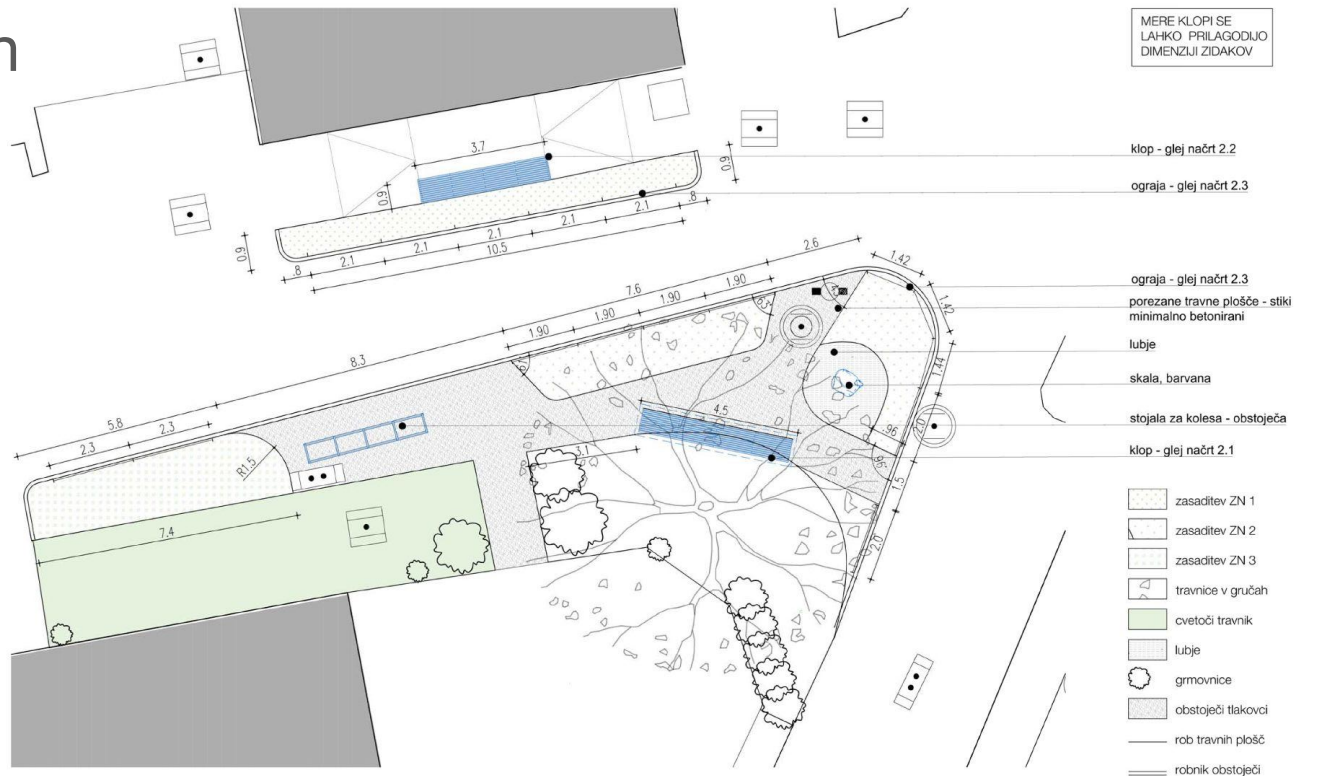

## kd prstoRož

Pimka 22, 1000 Ljubljana  
 t: +386 (0)60 18 000 e: prstoroz@gmail.com

naročnik: Mestna občina Ljubljana, Mestni trg 1, 1000 Ljubljana

objekt: VRTEC MARVICA

vrsta projekta: PZD število projekta

avtor arhitekture: **prstoRož**  
 Alenka Koneznik u.d.o., Mala Ovelka u.d.o.

merilo: 1:100 datum: avgust 2023

## 1.0 SITUACIJA

# Implementation



# Verification of criteria

- ✓ **Slowing traffic** - road width, greenery, grass pavement
- ✓ **Creating a pleasant living environment** - greenery, furnishings, materials
- ✓ **Traffic congestion** - changed traffic regime
- ✓ **Clearly designed entrance** - grass grates, floor painting
- ✓ **Universal accessibility** - no more raised kerbs
- ✓ **Encouraging sustainable mobility** - no parking in front of entrance, bike racks
- ✓ **Improving soil permeability** - grass pavement, greenery
- ✓ **Increasing the amount of green space** - perennials, shrubs, climbers



# Lessons learned



# Vodnikova street, Kindergarten Andersen



# Traffic regime

- Parking and stopping prohibited
- 30% of the total area stationary traffic
- 50% road





# Surfaces

Green surfaces



3%

Pedestrian surfaces



20%

Water-permeable surfaces



3%

Traffic surfaces



80%

# Removals

Area 1557 m<sup>2</sup>

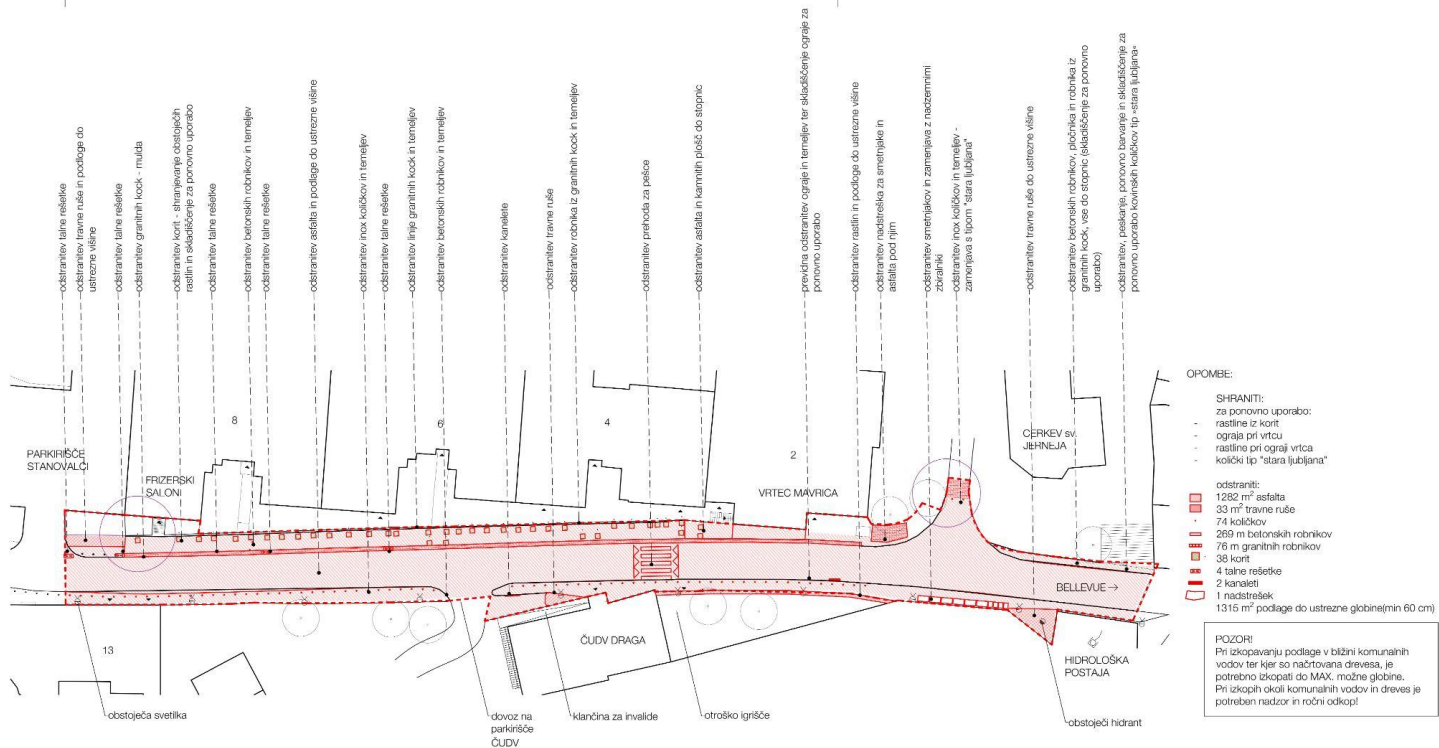

**Kombinat arhitekti d.o.o.**

Remeka 22, 1000 Ljubljana  
t. +386 (0)599 19 980



narobnik	Mestna občina Ljubljana, Mestni trg 1, 1000 Ljubljana
opis	<b>UDOBNE ULICE - UREDITEV OBMOČJA VODNIKEVE CESTE</b>
vrsta zvojnine dokumentacije	PZ
avtor arhitekture	<b>kombinat arhitekti d.o.o.</b> Mala Dolina ul. 2, Ane Ghisul. 2, Komenda Komenda ul. 2, Mesta Brezovca, Mestni trg, Lica Dima Valerij ul. 40, Ptica Komarčič ul. 2, Brezje, arh.
soizvajalci	
merilo	1:500
datum	november 2023

# Traffic

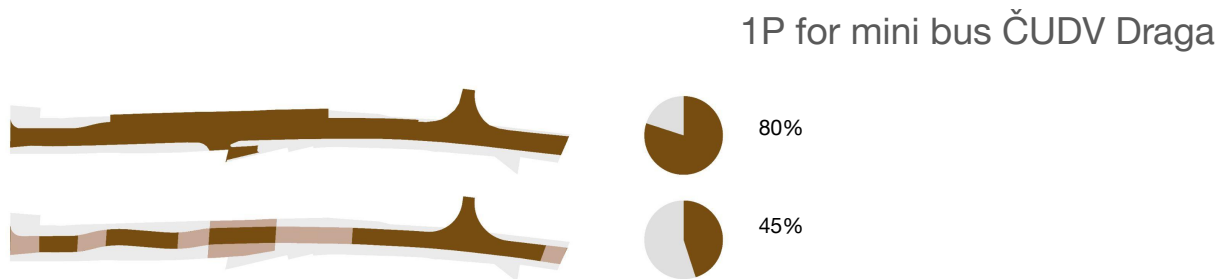
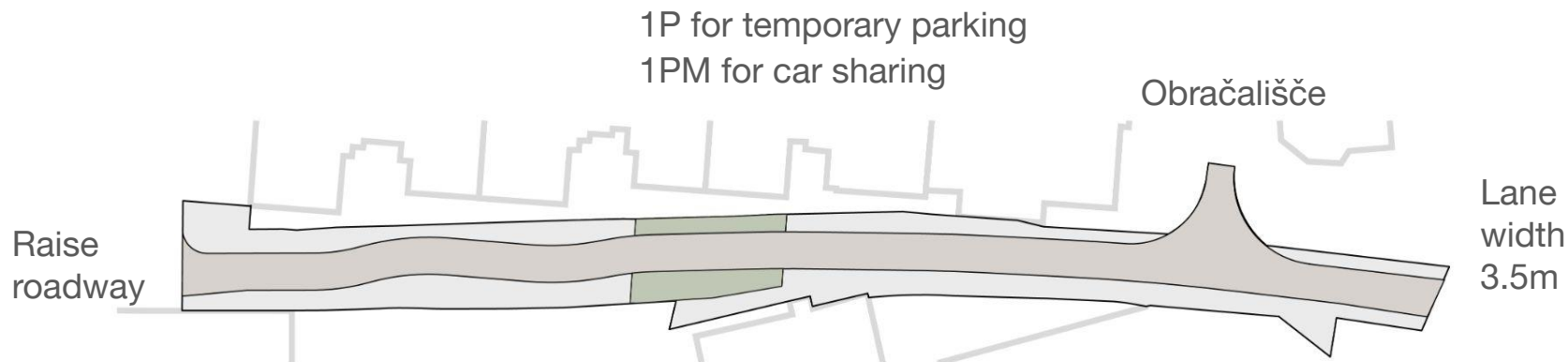

# Parterre greenery

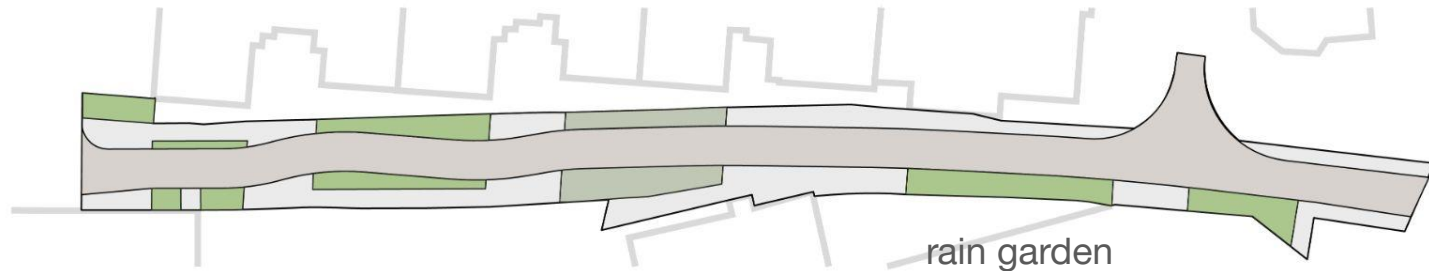
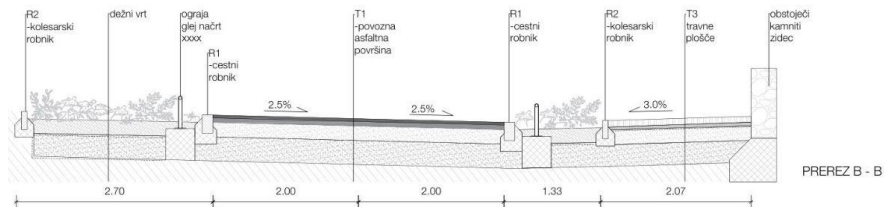

Rain gardens

rain garden  
as part of a  
children's  
playground

Cascading rain  
garden

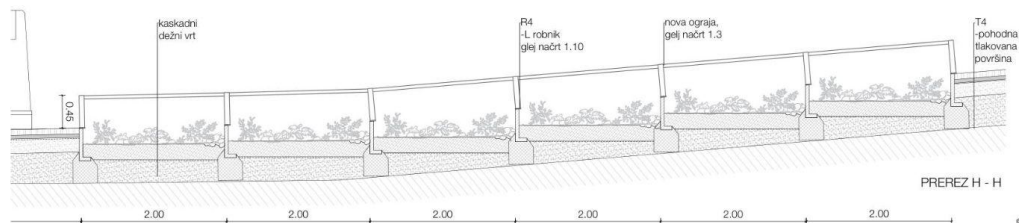
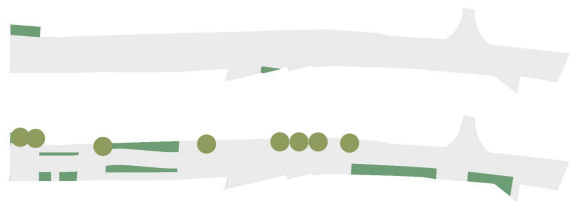

# Rain gardens

- 210 m<sup>2</sup> rain gardens

Zakaj ob nalivih vsakič poplavi podvoz na Celovski cesti v Ljubljani?

SLOVENIJA | Avtor: S. N. | 19. Sep 2022 10:33 | 11 komentarjev

Delite

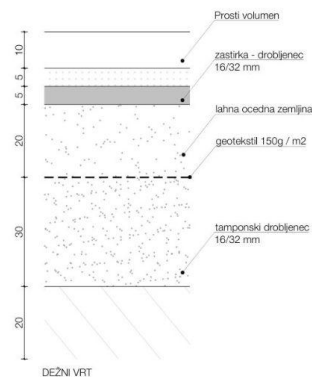
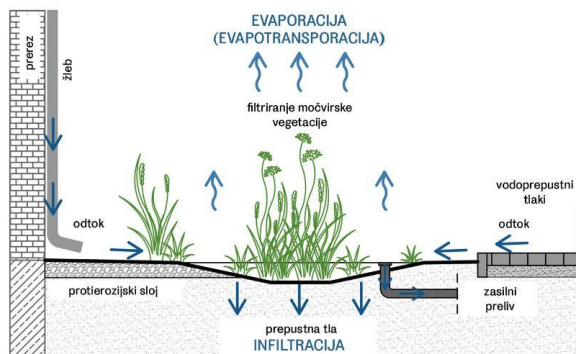

## Lokalno urejanje meteornih voda prispeva k razbremenitvi podvoza na križišču Celovška - Tivolska

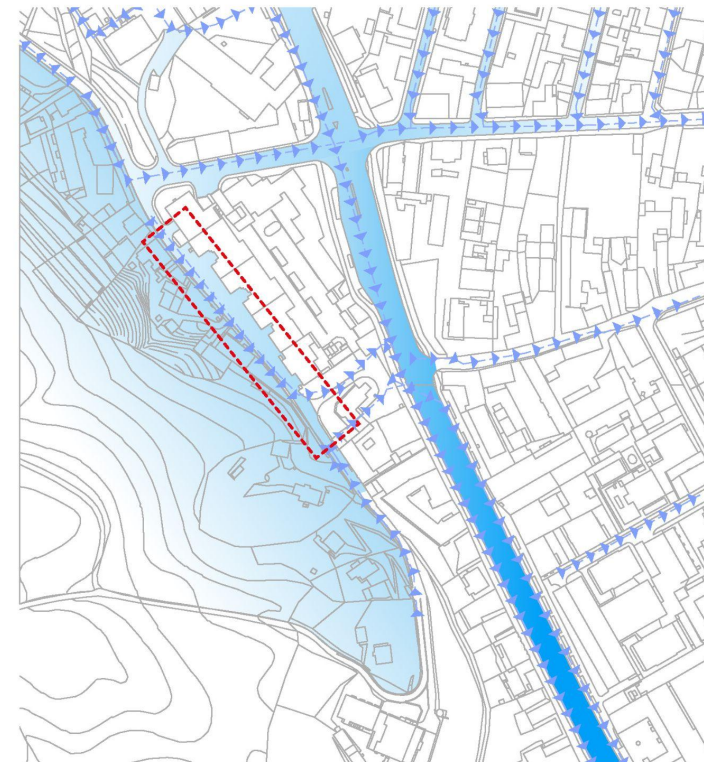

# Grass pavements

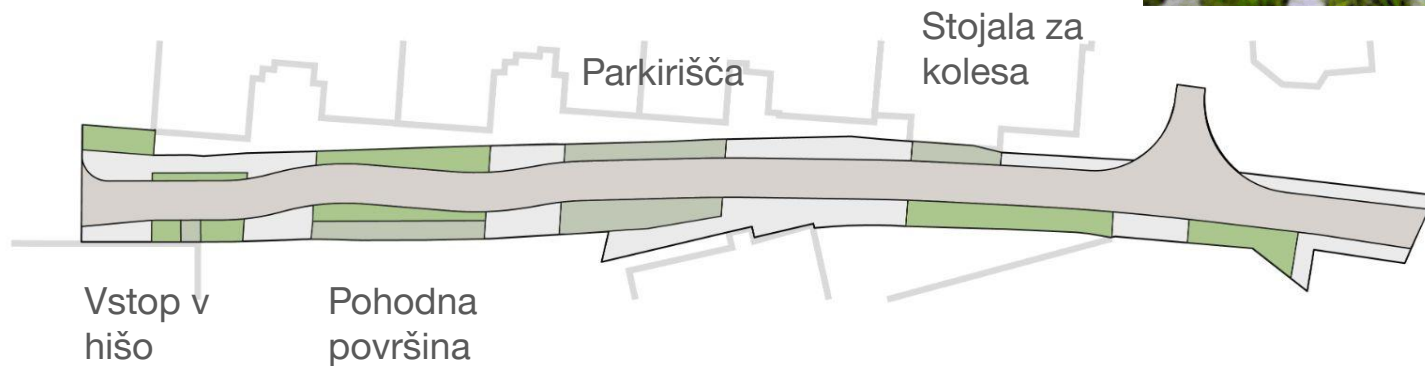

Vodoprepustne  
površine



# Permeable pavements



Tiled surfaces accentuate the vestibules of the blocks

Zone next to the blocks - pedestrian only

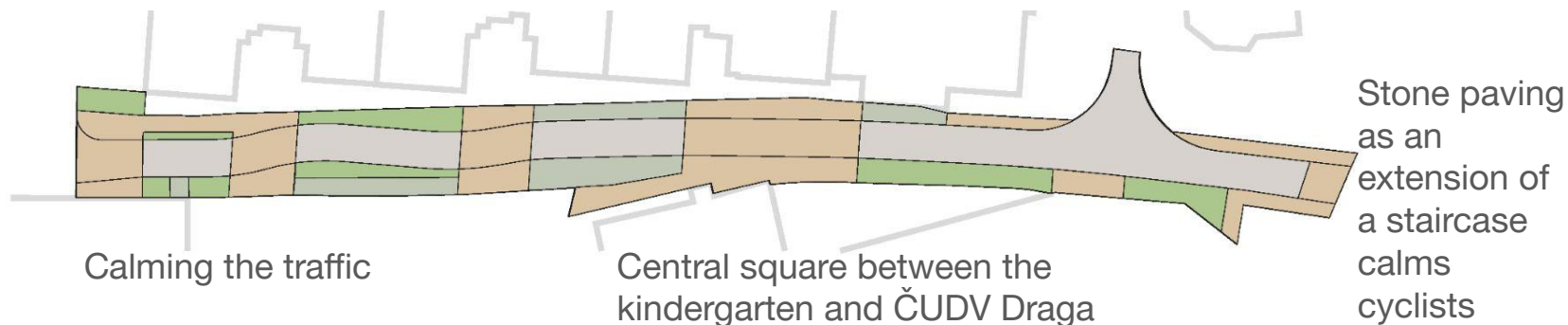

Pedestrian areas

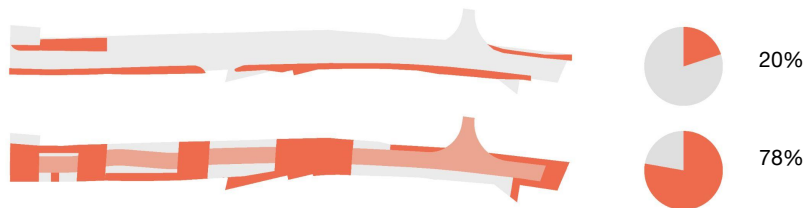

# Trees, equipment

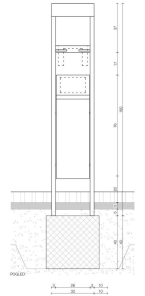
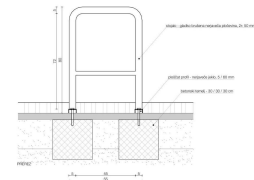
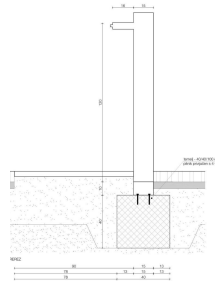
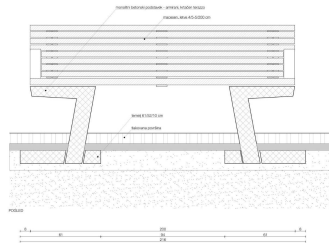
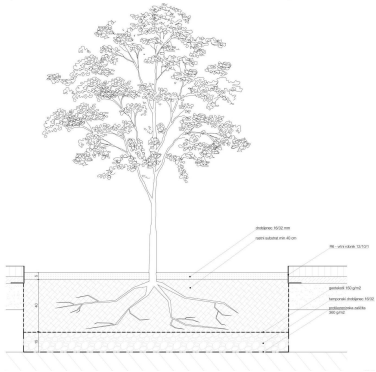
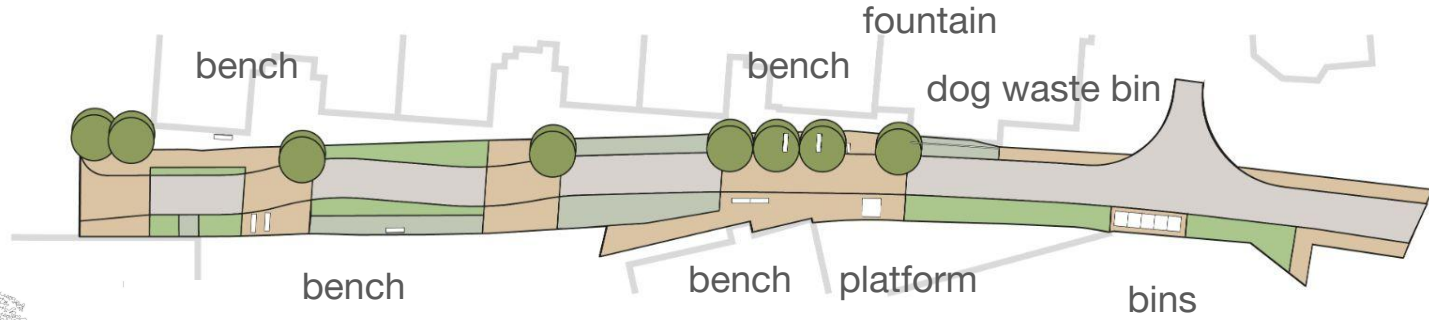



# Verification of criteria

- ✓ **Slowing down traffic** - road width, raising the road surface, meandering, greenery, trees
- ✓ **Creating a pleasant living environment** - greenery, furnishings, materials
- ✓ **Traffic congestion** - cul-de-sacs
- ✓ **Clearly shaped entry** - raising the road surface, paving
- ✓ **Universal accessibility** - no more raised kerbs
- ✓ **Encouraging sustainable mobility** - no parking, bike racks, PM for more sustainable forms of mobility
- ✓ **Improving soil permeability** - rain gardens, grass slabs
- ✓ **Increase green spaces** - 8 trees, greenery

# Surfaces

BEFORE / AFTER

Green surfaces

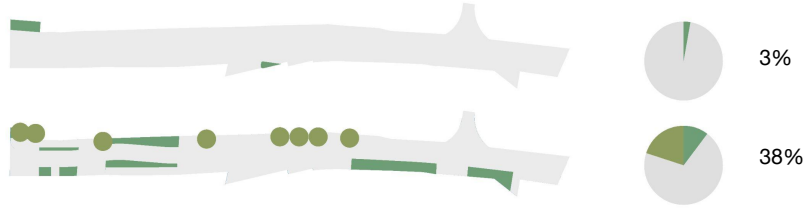

Pedestrian surfaces

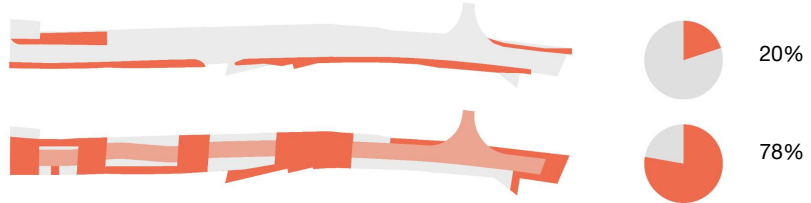

Water-permeable surfaces

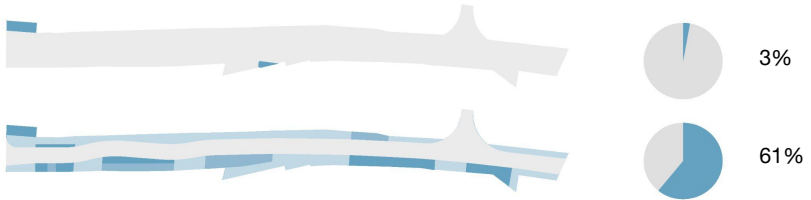

Traffic surfaces

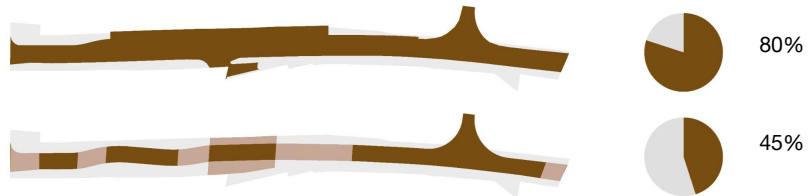

# Before / To be continued...?





[www.prostoroz.org](http://www.prostoroz.org)

[info@prostoroz.org](mailto:info@prostoroz.org)